

Braided Nitrile Racing Hose and Reusable Swivel Hose Ends



Stainless Steel Braided Nitrile Rubber Hose is very popular for use as oil hoses in race cars. The stainless steel cover resists abrasion and corrosion. Rated temperature: -55°F to 300°F (-48°C to 149°C). NHRA accepted. **Sold by the foot.**

Aramid Braided Startlite Hose has the same nitrile lining as the hose at left. The lightweight black aramid cover is abrasion and fire resistant. Rated temperature: -45°F to 300°F (-43°C to 149°C). NHRA accepted. **Sold by the foot.**



Standard Steel Braided Nitrile Fuel and Oil Hose							
Hose Size	Hose I.D.	Hose O.D.	Pressure Rating	Bend Radius	Weight per foot	Part No.	Price per foot
4AN	0.22"	0.44"	1,000 psi	2.00"	1.80 oz.	3270-04	\$5.99
6AN	0.34"	0.55"	1,000 psi	2.50"	2.16 oz.	3270-06	\$6.59
8AN	0.44"	0.65"	1,000 psi	3.50"	2.92 oz.	3270-08	\$7.39
10AN	0.56"	0.80"	1,000 psi	4.00"	3.75 oz.	3270-10	\$7.99
12AN	0.69"	0.94"	1,000 psi	4.50"	4.53 oz.	3270-12	\$9.49
16AN	0.88"	1.15"	750 psi	5.50"	6.04 oz.	3270-16	\$12.49

Startlite Aramid Braided Nitrile Fuel and Oil Hose							
Hose Size	Hose I.D.	Hose O.D.	Pressure Rating	Bend Radius	Weight per foot	Part No.	Price per foot
4AN	0.22"	0.43"	500 psi	2.00"	0.80 oz.	3492-04	\$9.49
6AN	0.34"	0.55"	500 psi	2.50"	1.28 oz.	3492-06	\$10.49
8AN	0.44"	0.64"	500 psi	3.50"	1.44 oz.	3492-08	\$12.49
10AN	0.56"	0.80"	500 psi	4.00"	2.24 oz.	3492-10	\$14.49
12AN	0.69"	0.93"	350 psi	4.50"	2.56 oz.	3492-12	\$16.79
16AN	0.88"	1.13"	350 psi	5.50"	3.04 oz.	3492-16	\$20.99

These reusable aluminum hose ends are red and blue anodized for corrosion protection and for a professional appearance. They are compatible with standard nitrile-lined racing hose, both stainless braided and Startlite types.

Bent Tube Swivel Hose Ends for Steel Braided or Startlite Hose - Red / Blue						
Angle	4AN	6AN	8AN	10AN	12AN	16AN
Straight	Part No. 3271-04-000 \$6.49	Part No. 3271-06-000 \$6.99	Part No. 3271-08-000 \$7.49	Part No. 3271-10-000 \$9.99	Part No. 3271-12-000 \$14.99	Part No. 3271-16-000 \$22.99
	Part No. 3271-04-045 \$15.49	Part No. 3271-06-045 \$16.49	Part No. 3271-08-045 \$18.49	Part No. 3271-10-045 \$21.99	Part No. 3271-12-045 \$24.99	Part No. 3271-16-045 \$28.99
45°	Part No. 3271-04-090 \$15.49	Part No. 3271-06-090 \$16.49	Part No. 3271-08-090 \$18.49	Part No. 3271-10-090 \$21.99	Part No. 3271-12-090 \$24.99	Part No. 3271-16-090 \$28.99
60°	Not Available	Part No. 3271-06-060 \$15.49	Part No. 3271-08-060 \$16.49	Part No. 3271-10-060 \$18.49	Part No. 3271-12-060 \$22.99	Part No. 3271-16-060 \$28.99
90°	Part No. 3271-04-090 \$15.49	Part No. 3271-06-090 \$16.49	Part No. 3271-08-090 \$18.49	Part No. 3271-10-090 \$21.99	Part No. 3271-12-090 \$24.99	Part No. 3271-16-090 \$28.99
120°	Not Available	Part No. 3271-06-120 \$23.99	Part No. 3271-08-120 \$25.99	Part No. 3271-10-120 \$28.99	Part No. 3271-12-120 \$30.99	Part No. 3271-16-120 \$33.99
150°	Not Available	Part No. 3271-06-150 \$23.99	Part No. 3271-08-150 \$25.99	Part No. 3271-10-150 \$28.99	Part No. 3271-12-150 \$30.99	Part No. 3271-16-150 \$33.99
180°	Not Available	Part No. 3271-06-180 \$23.99	Part No. 3271-08-180 \$25.99	Part No. 3271-10-180 \$28.99	Part No. 3271-12-180 \$30.99	Part No. 3271-16-180 \$33.99

Straight Swivel Hose End
Part No. 3271-Size-000

90° Bent Tube Style Swivel Hose End
Part No. 3271-Size-090

150° Bent Tube Style Swivel Hose End
Part No. 3271-Size-150

45° Bent Tube Style Swivel Hose End
Part No. 3271-Size-045

120° Bent Tube Style Swivel Hose End
Part No. 3271-Size-120

180° Bent Tube Style Swivel Hose End
Part No. 3271-Size-180

60° Bent Tube Style Swivel Hose End
Part No. 3271-Size-060

90° Forged Swivel Hose End
Part No. 3274-Size-090
"Cutter" style only.

In addition to the traditional red-and-blue hose ends shown in the table above, we now stock a full range of Black anodized bent tube style hose ends too! Simply order Part No. 3471-Size-Angle!

Forged "Cutter" Style Reusable Swivel Hose Ends

Angle	6AN	8AN	10AN	12AN
45°	Part No. 3274-06-045 \$20.99	Part No. 3274-08-045 \$23.79	Part No. 3274-10-045 \$39.99	Part No. 3274-12-045 \$34.49
90°	Part No. 3274-06-090 \$20.99	Part No. 3274-08-090 \$23.79	Part No. 3274-10-090 \$29.29	Part No. 3274-12-090 \$34.49

Note: The fittings shown here are **only** compatible with the standard nitrile-lined racing hose on this page. They are not interchangeable with fittings for the Type 811 and 910 PTFE lined hose on page 87.

Assembly Instructions for Standard Steel Braided and Startlite Nitrile Fuel and Oil Hose (3271, 3274, or 3471 Hose Ends)

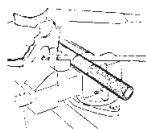

Step 1. Cut the hose squarely to length using a Cut-off Machine or a very fine tooth hacksaw. To minimize wire braid flare out, wrap hose with glass filament strapping tape. Do not remove tape until ready for step 2.

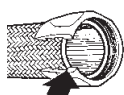

Step 2. Remove tape and then quickly insert hose into the socket before the braid begins to flare out. Insert hose with a twisting, pushing motion until hose is in line with back of socket threads. Use our Koul Tools for easy installation.

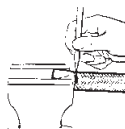

Step 3. Important: Mark position around hose at rear of socket with a grease pencil, paint or tape.

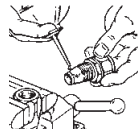

Step 4. Hold the socket in a vice with smooth or soft jaws. Lubricate inside of hose and nipple threads with SAE 30 lubricating oil or Aeroquip Hose Assembly Lube.

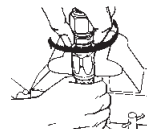

Step 5. Insert nipple and engage threads while holding hose in position with other hand. Make sure hose does not push out of socket by observing mark made in step 3.

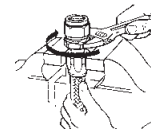

Step 6. Complete assembly using wrench while continuing to hold hose in position. Maximum allowable gap between socket hex and nipple hex is 0.031 inches.

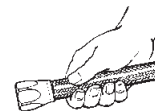

Step 7. Important: Check hose for push out by observing hose position mark. None should be evident. **Clean, proof test to twice operating pressure and inspect all assemblies.** Disassemble in reverse order.